



THE LUXURY TRAIN TRAVEL COMPANY

GRAND ALPINE EXPRESS

GOLDEN EAGLE | DANUBE EXPRESS



★ ITINERARY PAGE 5

★ PRICING & INCLUSIONS PAGE 22



CONTENTS

- 3 Map & Overview
- 5 Day by Day Itinerary
- 22 ... Tour Dates & Pricing
- 23 ... Inclusions & Exclusions
- 24 ... Why Book with Us?
- 25 ... Golden Eagle Difference
- 27 ... The Train & Cabin Classes
- 37 ... Important Information
- 39 ... Recommended Reading

ABOUT OUR COMPANY

Established as one of the leading, independent and family owned luxury train specialists, our focus is on well thought through private and personally selected rail adventures. Our emphasis is very much on the right trip for you and we work closely with you in order to achieve this. We regard the rail journeys we offer as a trip of a lifetime and use our experience and knowledge to make it that for you.

The Luxury Train Travel Company is a trading name of Headseast Ltd, a UK based, independent, family owned travel company. We operate several brands in addition to The Luxury Train Travel Company including [“The Latin America Travel Company”](#) [“The Trans-Siberian Travel Company”](#) and [“The China Travel Company”](#). Our clients come from all over the world.

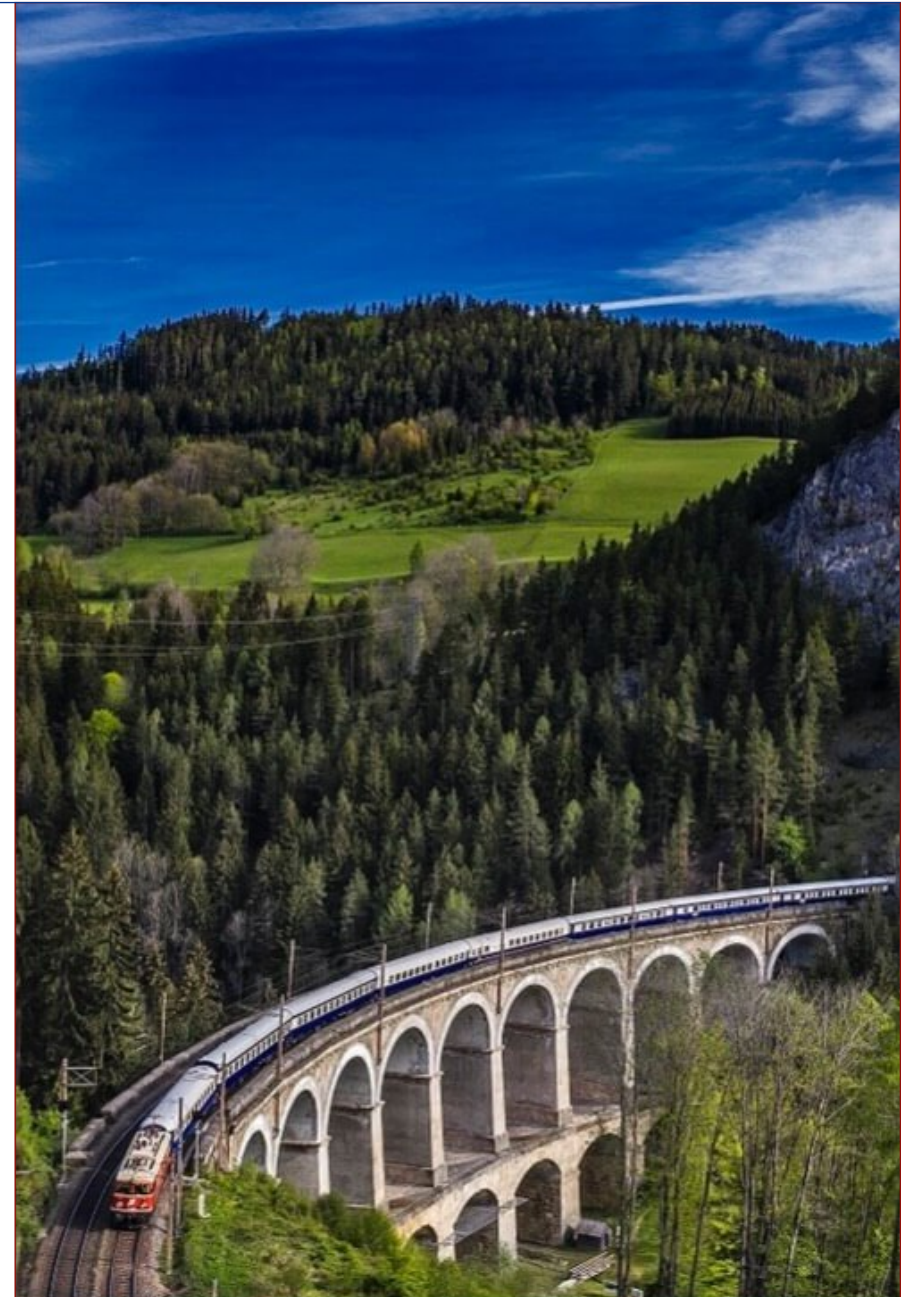

GOLDEN EAGLE DANUBE EXPRESS | GRAND ALPINE EXPRESS | 2025

10 NIGHTS / 11 DAYS

Budapest • Vienna •
Semmering Pass • Lake Achen
• Innsbruck • Zurich • St
Gotthard Pass • Lake Como •
Verona • Trieste • Lake Bled •
Ljubljana • Postojna • Venice

From the classic capital cities of Budapest and Vienna, we venture deep into the Austrian Tyrol before heading across the valleys of the Swiss Alps and onwards through the Italian Lake District before heading into the lesser-known but equally beautiful country of Slovenia and its jewel in the crown, Lake Bled.

Traverse some of the most scenic railway lines in the world as the Golden Eagle Danube Express weaves its way through tunnels, across viaducts and over mountain passes. Journeys end will be in the stunning maritime city of Venice, an outstanding mix of Gothic and Renaissance palaces perched on the edge of the Italian coast. A perfect end to a memorable journey of alpine discovery.



GOLDEN EAGLE DANUBE EXPRESS | GRAND ALPINE EXPRESS | 2025

Dear Sir / Madam,

Please find full details of this itinerary in this dossier. If you have any questions at all please do not hesitate to contact me.

Best regards,
The Luxury Train Travel Company.

THE LUXURY TRAIN TRAVEL COMPANY

- www.theluxurytraintravelcompany.com
- enquiry@theluxurytraintravelcompany.com
- ☎ +44 (0)20 8191 0620
- ABTA member Y1699
- ATOL License 10287

HIGHLIGHTS - PLEASE BOOK WELL IN ADVANCE

- Private concert at Vienna's Mozarthaus featuring the Vienna Supreme Orchestra.
- Travel over the spectacular Semmering Pass with its 16 viaducts and 15 tunnels.
- Take in the breathtaking beauty of Lake Bled on a special boat experience.
- Dine beside stunning Lake Como and tour the medieval village of Bellagio.
- Explore the ethereal Postojna Cave network of limestone caverns and monuments.
- Enjoy a gondola ride through the iconic waterways of romantic Venice.

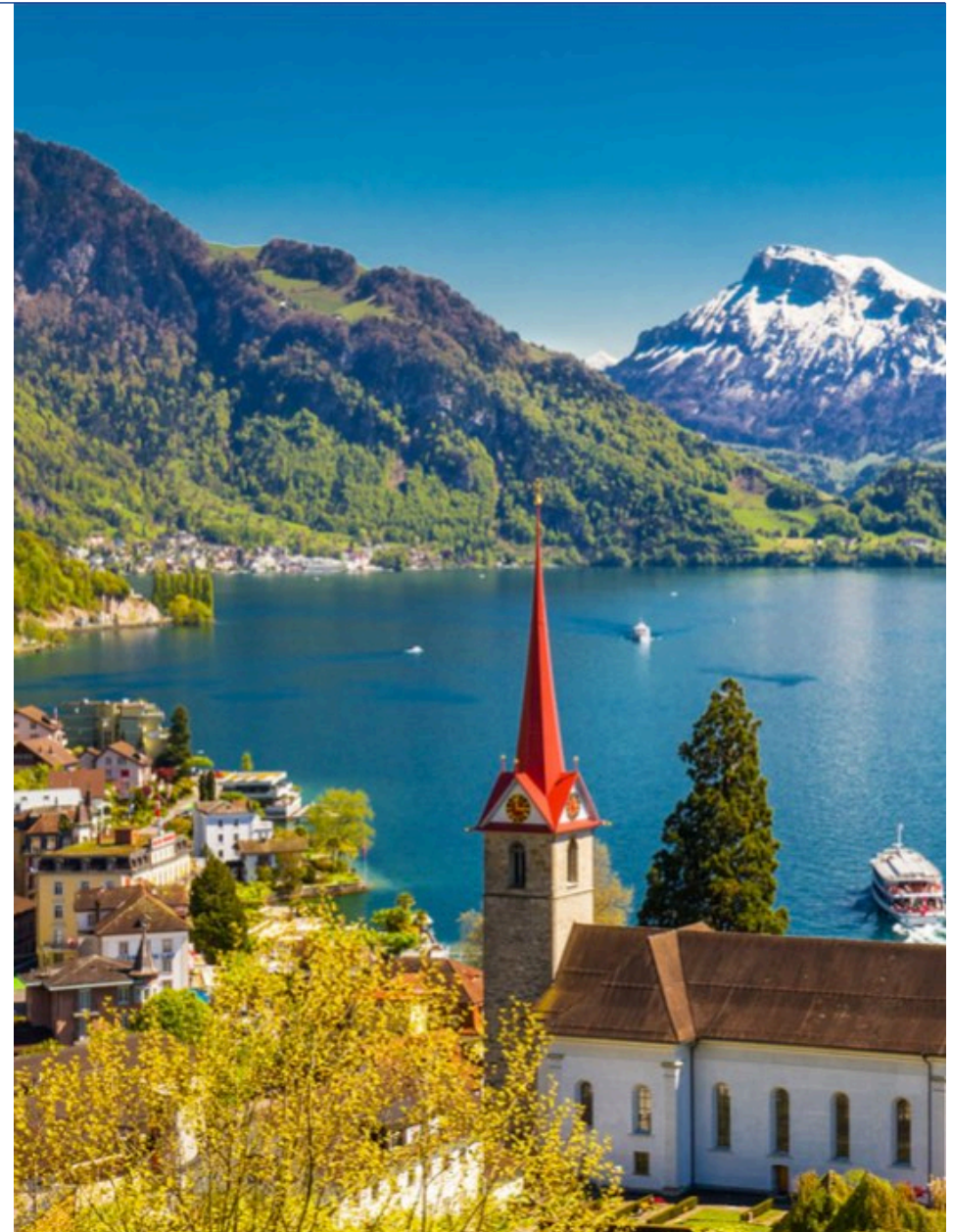



DETAILED ITINERARY

The following pages contain a detailed day by day itinerary for this trip. Note that all itineraries are subject to change and a final itinerary will be given shortly before your trip begins.

"I can't tell you how much we appreciate all the pre planning you helped us with. It was a trip of a lifetime experienced by few. Personally I feel privileged to have experienced this part of the world. Thanks again for all you did for us."

Gail & Cathy



YOUR DETAILED DAY BY DAY ITINERARY

DAY 1

BUDAPEST

ARRIVAL & A WELCOME RECEPTION & DINNER

On arrivals day in Budapest, you will be met at the airport, train station or river ship landing stage and transferred to the Four Seasons Hotel Gresham Palace for a two-night stay.

Enjoy a welcome reception dinner in the elegant surrounds of this art nouveau landmark, with its panoramic views across the River Danube, where you can meet your fellow travellers on this highly anticipated journey through Alpine Europe.

 **Meals Included:** Dinner.

A WARM WELCOME

From the moment our guests arrive, they are cared for by our professional train management team. On arrival at the airport or railway station, guests are met and transferred to our first night's stay in a 5 star hotel with no tipping or baggage handling charges to be concerned about.

On the first evening, all our guests are invited to a champagne reception prior to the welcome dinner, to get acquainted with fellow guests and to meet with the train management team and learn about the excitement that awaits them.

OVERNIGHT

FOUR SEASONS GRESHAM PALACE



Overlooking a park on the banks of the Danube, this luxe, art nouveau-style hotel has a lobby bar and a brasserie, plus a spa, gym and indoor pool.



*Hotel shown for guidance only with exact hotels not finalised until 6 weeks before the trip start date.

YOUR DETAILED DAY BY DAY ITINERARY

DAY 2

BUDAPEST

FULL DAY EXPLORING THIS BEAUTIFUL CITY

Budapest is two cities separated by the River Danube. The old city of Buda and the imposing Royal Palace dominate the city with stunning views across the Danube to the commercial heart of Pest. Our city tour includes the Royal Palace, St. Mathias Church and a panoramic view of the city from Gellert Hill. We will also see the Citadel, the Opera House, St Stephen's Cathedral, Heroes Square and the City Park.

The rest of the day is at leisure where you can stroll along the banks of the Danube, visit the historic Great Market Hall with its endless variety of delicious foods and wines or head to one of the city's famous thermal baths for a rejuvenating dip.

Alternatively, you can relax at the hotel and indulge in the hotel's luxurious spa with infinity-edge pool or make use of the state-of-the-art fitness centre.

 **Meals Included:** Breakfast, Lunch & Dinner.

GUIDED STOPOVERS ALONG THE WAY

We usually arrive into a new destination after a hearty breakfast, breaking off into groups of 20-25 people and exploring with local guides for the day. Each guest has their own personal headset, wirelessly connected to the guide for ease and convenience.

OVERNIGHT

FOUR SEASONS GRESHAM PALACE



Overlooking a park on the banks of the Danube, this luxe, art nouveau-style hotel has a lobby bar and a brasserie, plus a spa, gym and indoor pool.

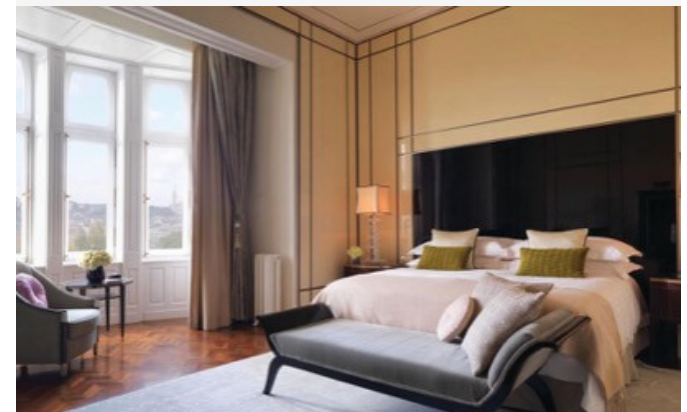

*Hotel shown for guidance only with exact hotels not finalised until 6 weeks before the trip start date.

HIGHLIGHTS OF THIS JOURNEY

BUDAPEST

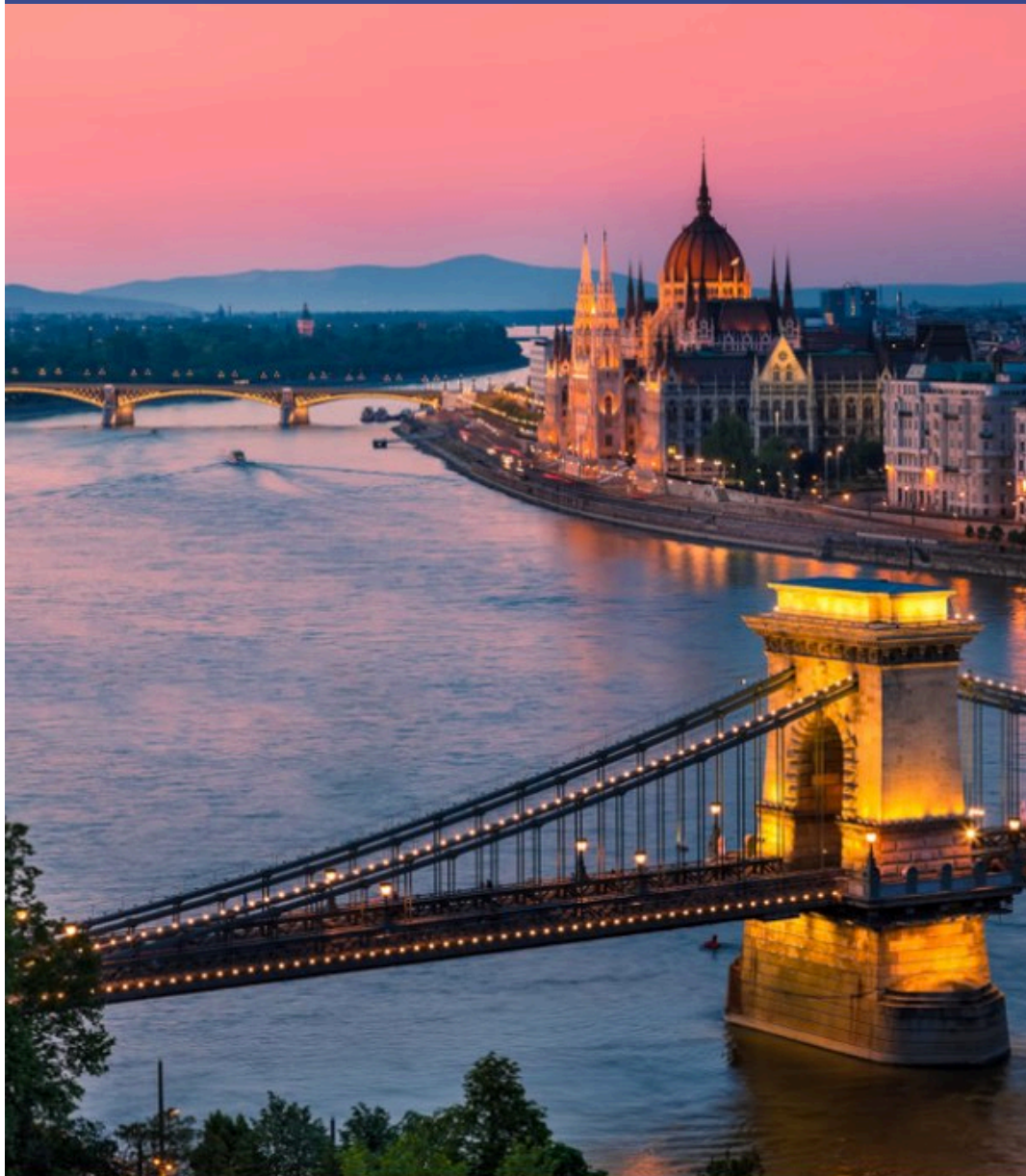

VIENNA



VIENNA

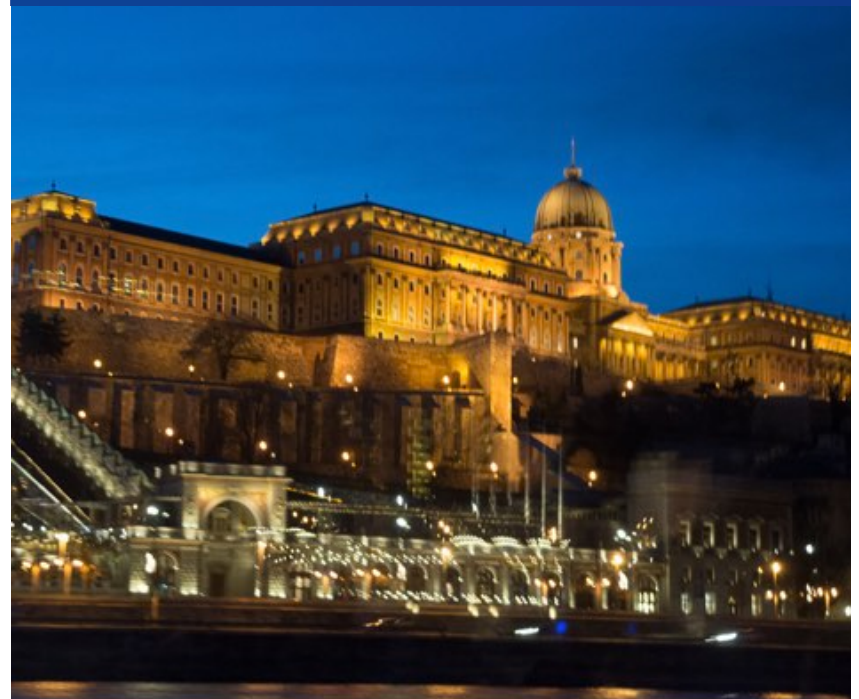

DAY 3

VIENNA

JOIN THE DANUBE EXPRESS & STOP IN VIENNA

We enjoy a morning drinks reception in the impressive Royal Waiting Room at Budapest Nyugati station before boarding the Golden Eagle Danube Express for our morning departure. Settle into your cabin and later enjoy lunch as the train heads to Vienna.

The stunning capital city of Austria enthralls visitors with its rich heritage. A seductive metropolis of elaborate palaces, renowned coffee houses, classical music and enchanting opera. Today's programme will allow you to sample the lively Naschmarkt, home to over 100 food and antique stalls, the famous Schönbrunn Palace, or free time to explore yourself.

This evening, we will enjoy a private concert featuring the Vienna Supreme Orchestra.

 **Meals Included:** Breakfast, Lunch & Dinner.

OVERNIGHT



BUDAPEST - VIENNA



DAY 4

AUSTRIA

TRAVEL TO LAKE ACHEN & INNSBRUCK

Today will be one of the real highlights of the journey as we depart from Vienna in the morning and travel across central Austria and into the Alps on an incredibly scenic morning.

Cameras at the ready as we climb over the Semmering Pass with its 16 viaducts and 15 tunnels, through the famous skiing village of Kitzbuhel to Jenbach, where after lunch we take a scenic drive to the picturesque Lake Achen (Achensee) for a cruise on the water.

From here we travel by bus the short distance to Innsbruck, capital of Austria's western state of Tyrol, a city in the Alps that's long been a destination for winter sports. Innsbruck is also known for its Imperial and modern architecture. The Nordkette funicular, with its futuristic stations designed by architect Zaha Hadid, climbs up to 2,256m from the city centre for stunning bird eye views of the surrounding Alpine terrain.

 **Meals Included:** Breakfast, Lunch & Dinner.

OVERNIGHT



VIENNA - INNSBRUCK



HIGHLIGHTS OF THIS JOURNEY

SEMMERING PASS



LAKE ACHEN



INNSBRUCK



DAY 5

AUSTRIA & SWITZERLAND

RAIL THROUGH THE VORARLBERG & ON TO ZÜRICH

Another fantastic morning ahead to simply sit back, relax and watch the scenery of the Vorarlberg unfold in front of your eyes as we pass through St. Anton before crossing through Liechtenstein and then into Switzerland where we run along the whole of the Lake of Zürich before arriving in the city itself.

The city of Zürich, a global centre for banking and finance, lies at the north end of Lake Zürich in northern Switzerland. The picturesque lanes of the central Altstadt (Old Town), on either side of the Limmat River, reflect its pre-medieval history. Waterfront promenades like the Limmatquai follow the river toward the 17th-century Rathaus (Town Hall). Whilst in the city we will enjoy a traditional Swiss fondue tasting.

 **Meals Included:** Breakfast, Lunch & Dinner.

OVERNIGHT



INNSBRUCK - ZÜRICH



DAY 6

SWITZERLAND & ITALY

ST GOTTHARD PASS, LAKE COMO

Today is one for the cameras! Upon leaving Zürich we pass along the shorelines of Lakes Zug and Lucerne before starting the very scenic climb to the St Gotthard Pass. Once through the old St Gotthard tunnel we descend through Lugano towards Lake Como in Italy, where we stop for lunch on the Lake.

Lake Como is surrounded by high mountains and dramatic cliffs, so it is quite different from the other Italian lakes. A narrow road runs up its western coast towards Switzerland and sits up high above the water, with the towns dropping down beneath it. Renowned for its beautifully kept public gardens and historic villas, it is easy to see why so many celebrities love Lake Como. We enjoy boat cruise on Lake Como and visit the beautiful lakeside town of Bellagio.

 **Meals Included:** Breakfast, Lunch & Dinner.

OVERNIGHT



ZÜRICH - MILAN



HIGHLIGHTS OF THIS JOURNEY

ZURICH



LAKE COMO



ST GOTTHARD PASS



YOUR DETAILED DAY BY DAY ITINERARY

DAY 7



VISIT VERONA & TRIESTE

This morning after running along the south shore of Lake Garda we arrive in Verona. Famous for being the setting of Shakespeare's 'Romeo and Juliet', we enjoy an informative walking tour of Verona's famous sites, including the first century Roman Amphitheatre in Piazza Bra.

We lunch on board and later in the afternoon we arrive into Trieste, the Italian port for a short tour. We stop at the imposing Miramare Castle and also visit the vast Piazza Unita d'Italia, the main town square. Standing on a hill overlooking Trieste is the famous Church of San Giusto built around a medieval complex and dates back to the 13th century. We will go inside the church for a close-up view of the splendid Byzantine-style architecture enriched with precious mosaics.

 **Meals Included:** Breakfast, Lunch & Dinner.

OFF TRAIN EXCURSIONS

Our "Freedom of Choice" excursion program includes a selection of land-tours in each location visited on every departure, formulated by our experienced train management team to get the very best out of each and every destination. Passengers may choose from our most popular excursion programs featuring historic and cultural highlights.

OVERNIGHT



MILAN - TRIESTE



DAY 8

ITALY & SLOVENIA

TOUR LAKE BLEED & LJUBLJANA

This morning be awake early as our train climbs away from Trieste and heads over the border into Slovenia and continue climbing through the Julian Alps to Lake Bled which, with its island, church and castle is an incredibly picturesque alpine lake situated at the foothills of the Alps in north-western Slovenia.

From here we travel onto Ljubljana as we have lunch on board and discover a delightful combination of ancient architecture and a youthful culture. Our afternoon tour includes visits to Preseren Square, Three Bridges and Dragon Bridge.

 **Meals Included:** Breakfast, Lunch & Dinner.

A FULLY CATERED EXPERIENCE

Guests can relax completely as they are fully catered for whilst off the train; a complimentary Golden Eagle backpack is provided to carry personal incidentals together with the free mineral water provided. All entrance fees are included as well as gratuities, and a delicious 3 course lunch with wine is served at a good local restaurant. In fact, there's so much included that our guests could easily explore each day without the need for cash.

OVERNIGHT



TRIESTE - VENICE



HIGHLIGHTS OF THIS JOURNEY

VERONA



LAKE BLED



LJUBLJANA

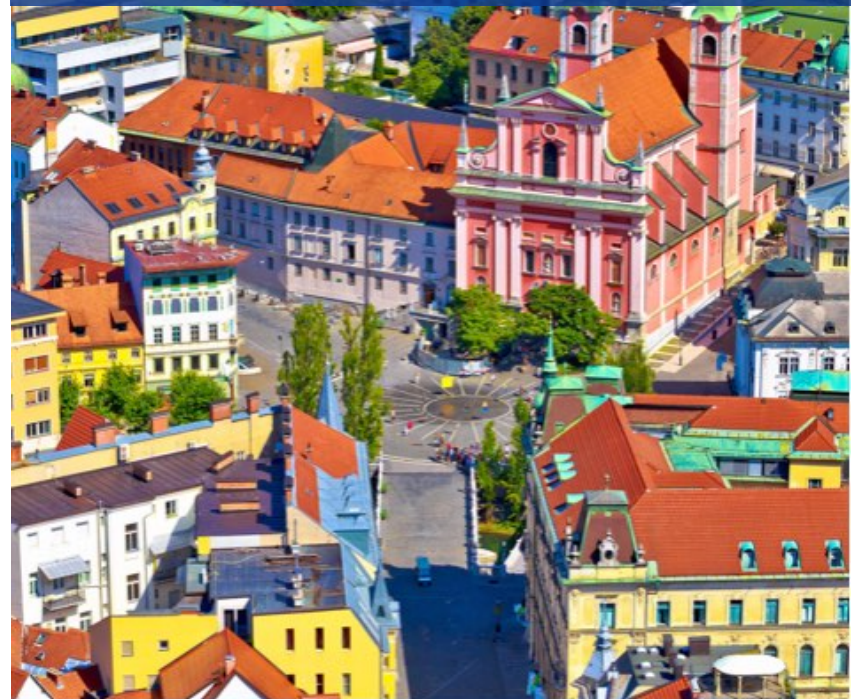

DAY 9

SLOVENIA & ITALY

POSTOJNA & VENICE WHERE WE LEAVE THE TRAIN

As the train stays overnight in Postojna, we include a private visit to Postojna Caves in the morning. We then head south towards Mestre where our train curves to the left onto the 3-mile causeway across the Venice Lagoon and into Venice Santa Lucia station located on the Grand Canal, arriving after lunch.

We say farewell to our train crew and transfer to a centrally located hotel in Venice for a two-night stay.

 **Meals Included:** Breakfast, Lunch & Dinner.

OVERNIGHT

SAN CLEMENTE PALACE



Offers luxury on a private island, featuring elegant rooms, gourmet dining, and breathtaking lagoon views all a short ride from the sights.



*Hotel shown for guidance only with exact hotels not finalised until 6 weeks before the trip start date.

DAY 10

VENICE

A DAY TOURING THIS BEAUTIFUL CITY & FAREWELL DINNER

Venice is a truly captivating and romantic city; its unrivalled beauty takes away the breath of first-time visitors and regulars alike. Today enjoy a walking tour around the highlights of this spectacular city.

Walk through the winding lanes beside the Grand Canal to St. Mark's Square, which for 1,000 years was the heart of Venetian life. We also see St. Mark's Basilica and stroll through the Rialto Market. A trip to Venice would not be complete without a gondola ride along Venice's famous canals (we include a 30 minute gondola in the programme).

Alternatively enjoy the city at your own pace today. Perhaps stroll through the artists' district of Dorsoduro, stopping to take in the city's most breath-taking views from the Accademia Bridge.

In the evening we will enjoy a farewell reception dinner, giving you the opportunity to reflect on your journey through this beautifully scenic part of Europe.

 **Meals Included:** Breakfast, Lunch & Dinner.

OVERNIGHT

SAN CLEMENTE PALACE



Offers luxury on a private island, featuring elegant rooms, gourmet dining, and breathtaking lagoon views all a short ride from the sights.



*Hotel shown for guidance only with exact hotels not finalised until 6 weeks before the trip start date.

HIGHLIGHTS OF THIS JOURNEY

VENICE



POSTOJNA



VENICE



DAY 11

END OF TOUR

DEPART VENICE OR EXTEND YOUR STAY IN ITALY

Following breakfast you will be transferred to the airport for onward departures.

Why not extend your stay in Venice to explore more of the city at your leisure? Please contact us for hotel options, touring programmes and rates.

 **Meals Included:** Breakfast.



2026

Updated 140725

GRAND ALPINE EXPRESS 2025 DATES & PRICES PER PERSON IN GBP / USD / EURO *

Starts in Budapest on the 1st May 2026 & finishes in Venice on the 11th May 2026

* All Dates Subject To Availability - Many Trips Sell Out Long In Advance *

CABIN	DELUXE			SUPERIOR DELUXE		
	See following pages for cabin description			See following pages for cabin description		
TWIN	£ 16,400	\$ 21,300	€ 19,700	£ 20,900	\$ 27,200	€ 25,200
SINGLE	£ 24,500	\$ 31,700	€ 29,400	£ 35,100	\$ 45,400	€ 42,100
Deposit	25%	25%	25%	25%	25%	25%

* The published prices for this tour are as listed above in GB Pounds, US Dollars and Euros. However, we can quote and accept payment in Singaporean Dollars, Australian Dollars, Canadian Dollars and more. **Contact us** for a confirmed quote in your preferred currency.

TOUR INCLUSIONS

- ✓ 5 countries: Hungary, Austria, Switzerland, Italy & Slovenia.
- ✓ 2 hotel nights in Budapest 5*.
- ✓ 6 nights private en-suite cabin on the Golden Eagle Danube Express.
- ✓ 2 hotel nights in Venice 5*.
- ✓ Freshly prepared meals on board, using the finest local ingredients.
- ✓ Authentic dining experiences in local restaurants.
- ✓ Inclusive alcoholic and non-alcoholic beverages from Standard Bar list.
- ✓ 10 Breakfasts, 9 Lunches, 10 Dinners.
- ✓ Expertly guided off-train excursions as detailed in the itinerary.
- ✓ Freedom of Choice touring options.
- ✓ Cabin attendant service including evening turndown.
- ✓ Experienced Tour Management team.
- ✓ Services of a UK-registered Doctor and medical facilities on board.
- ✓ Arrival and departure transfers.
- ✓ All gratuities – on and off the train.
- ✓ Luggage portage throughout the journey.

NOT INCLUDED IN THIS TOUR

- ✗ International Airfare to / from the start / finish of the trip.
- ✗ Visas - we can advise and partner with [VisaCentral](#).
- ✗ Travel Insurance to cover any medical treatment etc.
- ✗ Discretionary gratuities to drivers and guides.

IMPORTANT INFORMATION & T & Cs

- The tour may be cancelled if the minimum number of participants required for a trip is not met. It is rare this happens and if it does you will be offered a date / trip change or refund of the deposit (any decision is taken outside 90 days before the trip start date). Note there may be no refund for additional services such as flights or other travel arrangements you have made separately.
- We require all clients to take out travel / trip cancellation and to have valid medical insurance for all our trips.
- Due to the intricate logistics of this tour, itinerary changes are sometimes unavoidable.
- On booking a deposit of 25% plus any international flights we are booking for you.
- Full payment is required 90 days before the trip start date.
- International flights, visa fees and any services not mentioned are not included in the price.

Updated Cancellation Terms from 1st October 2025:

- Up to 91 days prior to departure: 10% plus any flights we book for you.
- 90-61 days or less prior to departure: 50% of total price.
- Within 60 days or less prior to departure: 100% of total price.
- Any part of the program that is missed because of late arrival is non-refundable.

WHY BOOK THROUGH US ?

EXPERIENCE ✓

We have been arranging luxury train tours since 2008 and have long relationships with key providers.

PRICE PROMISE ✓

In most cases we will offer to match any bona fide, like for like quote for your trip from another agent or operator.

INDEPENDENT ADVICE ✓

We give open and impartial advice and it is important to us that you book the right rail trip for you.

PEACE OF MIND ✓

We are members of ABTA and most trips are protected by our IPP cover and ATOL bonding.



"I just wanted to say thank you for organising our wonderful holiday. All went smoothly and we were well taken care of. Thank you for the seamless organisation."

Kristopher Forbes



"The trip was great. Everything was smooth. This was very important to me as a solo female traveller. I felt safe and secure at all times. It was a well-balanced and organised trip. I really appreciated the effort that went into the trip."

Sarah Orozco



"You are amazing! Thank you so much for the fast response to my initial email, and the rapid answer to any questions I had, no matter how stupid they were! Your organisation was a great choice for me... I would highly recommend it."

Rachael Klein



"The booking process was very efficient. We appreciate you answered all our questions and presented a good plan. The trip itself was a wonderful old world Africa experience on the train – loved it."

Paige & Hugh Christensen



"It was the best trip we've ever taken! It was amazing! I cannot say enough about it. The ease of train travel, and guides were all pleasant surprises."

Lawrence & Conner Dudley



"We appreciated how easy it was to talk with you on the phone, person-to-person. This was very helpful. It's nice to meet people with similar interests and goals. We thank you and your company for everything you did to create a memorable train experience."

Bethany Leblanc



"You made booking flights and everything else very simple. You always provided excellent service, and responded to our inquiries promptly. Thanks for your attention to detail towards your customers."

Tania & Arthur Lindsey



"I can't tell you how much we appreciate all the pre planning you helped us with. Thanks again for all you did for us."

Gail & Cathy

THE GOLDEN EAGLE DANUBE EXPRESS DIFFERENCE

• EXPERIENCED TOUR MANAGERS

Our experienced tour managers and their assistants are selected for their travel knowledge and their linguistic and organisational abilities allowing you to relax and enjoy your rail cruise. We receive exceptional passenger comments about our Tour Managers and their aim is to ensure you enjoy every minute of your holiday.

• HOTEL & TRAIN ACCOMMODATION

Although you will spend much of your time sightseeing or relaxing in the train's public areas, you will find your hotel room or cabin a welcome retreat at the end of a rewarding day. All hotels are of 5 star standard or, in certain locations, the best available. Room upgrades are available on request and at extra cost.

• WELCOME & FAREWELL DINNERS

Each tour begins with a Welcome Dinner, an ideal opportunity to get to know your fellow passengers; for the Tour Manager to brief you on the trip; and introduce you to the Golden Eagle Luxury Trains team and the Tour Doctor. The Farewell Dinner is the perfect end to your adventure by private train where you can relive the journey and look ahead to future tours.

• GUIDE & INFORMATION PACK

When you board the train there will be a brochure in your cabin detailing more about your journey and the places en-route. Our Tour Manager will organise a programme of briefings on the cities or places we visit and, each evening, will issue a programme for the next day's touring schedule.

• BREAKFAST, LUNCH & DINNER

All departures feature one or two uniquely designed restaurant cars where you can enjoy the excellent waiter-served food and wine. Several times during the tour we will also sample authentic local cuisine off the train.

• DRINKS WITH MEALS

A generous drinks allowance is included with lunch and dinner. For passengers travelling in Gold Class onboard the Golden Eagle, drinks from the Standard Drinks List in the Bar Lounge Car are also included. For Imperial Suite guests, drinks from both the Standard and Premium Bar Lists in the Bar Lounge Car are included.

• ONBOARD SERVICE

You can expect service which is attentive, friendly and unintrusive. Your car attendants provide 24-hour housekeeping and bedding turndown services, with one attendant always on duty to assist you and to ensure you are comfortable in your cabin. Complimentary tea, coffee and bottle drinking water are available in your cabin 24 hours a day.

• GUIDE DURING EXCURSIONS

The history and culture of the places we visit on our rail cruises will come alive through our expert local guides. All our tours include a wide-ranging sightseeing schedule to make the most of the time you have off the train and bring you closer to the culture, people and history of your destinations. We believe it is the special little touches that help create magical memories. Imperial Suite guests will benefit from the option of a private car and guide in the majority of places we visit along the route.

• ALL GRATUITIES

You will not have to worry about tipping on and off the train on your rail journey with Golden Eagle Luxury Trains as all gratuities are included in the tour price.

THE GOLDEN EAGLE DANUBE EXPRESS DIFFERENCE

• FREEDOM OF CHOICE TOURING

Customise your journey and enjoy the opportunity to select from an array of Freedom of Choice Touring options that best suits your interests. Your off-train excursions will still take in all the major attractions of the places we are visiting but, in featured locations, you will be presented when you are onboard the train with a variety of activities from which to choose, and enjoy a tailor-made experience. Look at the individual itineraries where we are operating Freedom of Choice Touring.

Freedom of Choice Touring options may be subject to variations dependent on finalised train timings and local charges. Touring options available will typically be advised in the evening prior to the day's tour.

• PERSONAL HEADSETS

On all the off-train excursions, to enhance your enjoyment and comprehension of the places you visit, you will be provided with a lightweight personal headset on which to listen to your tour guide as you take in the sights. So you do not need to worry about missing any of the interesting details on your excursions.

• DOCTOR & MEDICAL FACILITIES

To give you peace of mind our tours are accompanied by a doctor who travels with us for the entire journey; so you can rest assured that medical assistance is always available. On call 24 hours a day, the doctor is on hand to give primary care as required. Normally, the doctor will be English speaking and be registered with the General Medical Council in the UK.

• 24 HOUR SERVICE ATTENDANT

Your car attendants provide 24-hour housekeeping and bedding turndown services, with one attendant always on duty to assist you and to ensure you are comfortable in your cabin. Complimentary tea, coffee and bottled drinking water are available in your cabin 24 hours a day.

• PORTERAGE

As you only have to unpack once, your luggage and belongings will stay with you on the train throughout the journey but, wherever necessary, portorage is included between the hotel and stations.

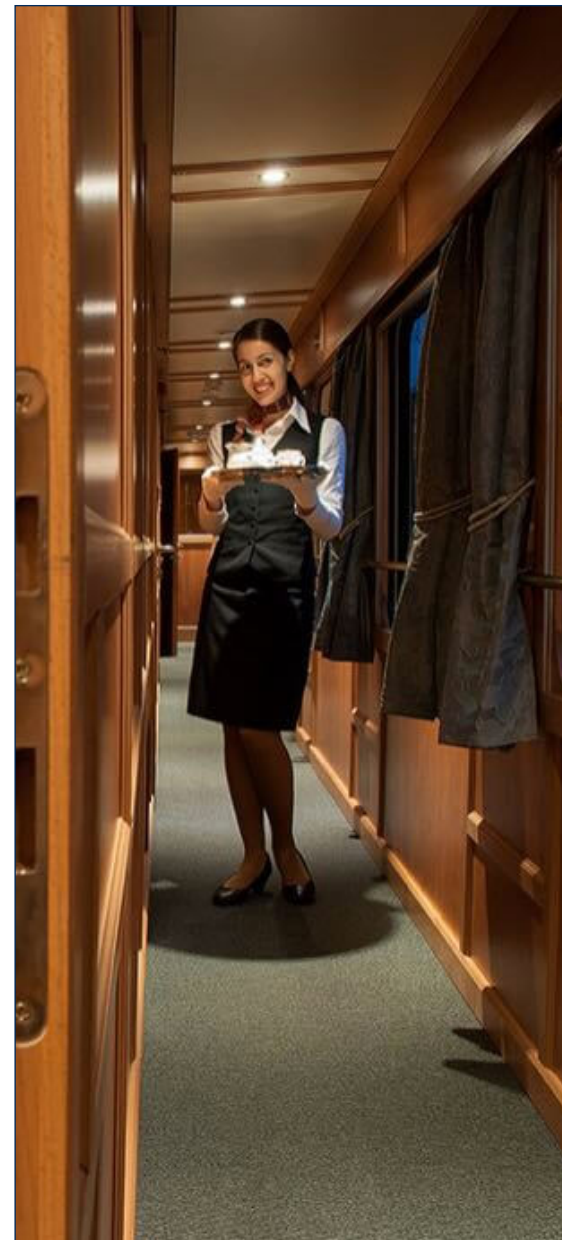

ABOUT THE DANUBE EXPRESS TRAIN

The Golden Eagle Danube Express is your luxurious hotel-on-wheels. Unpack just the once and settle into your well-appointed and comfortable cabin as you begin this voyage of a lifetime.



THE BAR LOUNGE CAR

The social heart of the Golden Eagle Danube Express is the Bar Lounge Car, a great place to relax and settle into the unhurried pace of life on board.

Unwind in comfortable surroundings and watch the world go by as you get to know your fellow passengers and begin long-lasting friendships. Perhaps read a novel to while away the time or challenge your friends to a game of cards.

It is here that our Tour Manager will also organise a programme of activities. Passengers will receive printed daily itineraries throughout the tour detailing train arrival and departure timings, latest weather forecasts for the next destination and information on the following day's excursions and activities.

The Bar Lounge Car and Restaurant Cars will host an entertaining and enlightening range of activities such as language lessons and engaging talks by expert lecturers on local history and culture.

In the evening enjoy the sounds of the resident pianist playing in the Bar Lounge Car. Every night the bar stays open until the last person leaves.





THE RESTAURANT CAR

The Golden Eagle Danube Express restaurant cars are a delightful venue in which to enjoy meals skilfully prepared by our Executive Chef and his onboard restaurant team using the very best in ingredients, locally sourced wherever possible. Depending on the number of guests onboard, one or two of our restaurant cars will be on every departure.

Enjoy the delights of an on-train breakfast each morning - a wide selection of fruit, cereals, orange juice and cold plates are available from our bountiful buffet. Alternatively enjoy a cooked breakfast bought to your table by our waiting staff, all complemented by steaming hot tea and coffee.

For lunch and dinner you will enjoy fine food, great wines and attentive service in the welcoming atmosphere of the restaurant car. We offer a culinary experience that reflects the very essence of the countries we travel through, as well as international cuisine. Vegetarian and other dietary options are also available.

All our meals at lunch and dinner are complemented by an excellent choice of wines from around the world, personally selected by our Company Founder, Tim Littler, along with bottled water, beer and soft drinks.

Meals onboard are a relaxed affair as the restaurant cars can accommodate all our guests in a single sitting. Throughout the journey there is an informal dress code, so you can enjoy our culinary experiences in convivial and relaxed surroundings and with our open-seating policy you can dine wherever, and with whomever, you please.

SUPERIOR DELUXE

The new Superior Deluxe cabins, with private en-suite facilities, offer the ultimate in European rail accommodation in terms of space, facilities and comfort.



Photos and illustrations are for guidance only and may differ to your actual cabin

SUPERIOR DELUXE

With 12 cabins per departure, each cabin offers comfortable daytime seating with a full length sofa and two additional chairs. The large cabin also benefits from two full-size picture windows, one of which is openable to add to the bright and airy feel of the interior.

Each evening the cabin is transformed into a luxurious bedroom with a UK-standard King Size bed. All cabins have, as standard, a large double wardrobe with excellent storage space, individually controlled air-conditioning, lighting with dimmer switches, individual reading lights, in cabin Wi-Fi and USB ports, power sockets and a safe.



SUPERIOR DELUXE

Photos and illustrations are for guidance only and may differ to your actual cabin.

- Cabins per car: 4
- Cabin length (inc. bathroom): 454cm (14'9")
- Cabin width: 190cm (6'2")
- Cabin area (inc. bathroom): 8.6 m2 (93 ft2)
- Bed size: 190cm x 152cm (6'2" x 5'0")
- King Size bed (UK standard)
- Additional daytime seating with table
- Individually controlled air-conditioning and heating
- Two large picture windows
- Adjustable lighting
- Double wardrobe
- Personal safe
- Wi-Fi & two USB ports
- Private en-suite bathroom with cubicle shower and WC

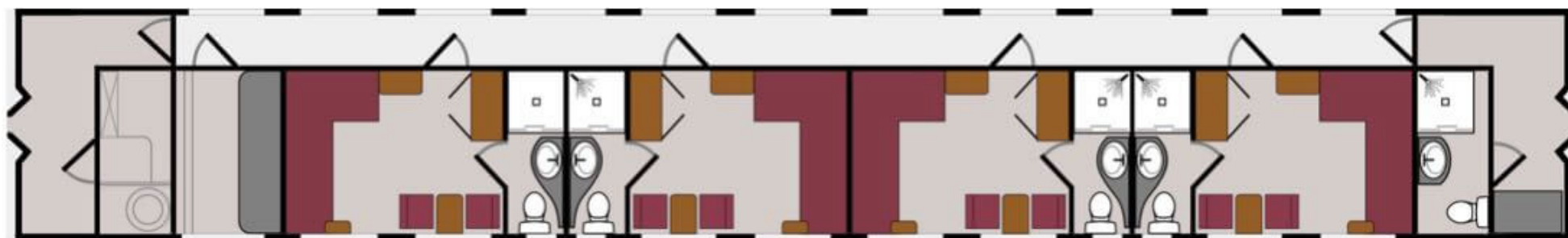
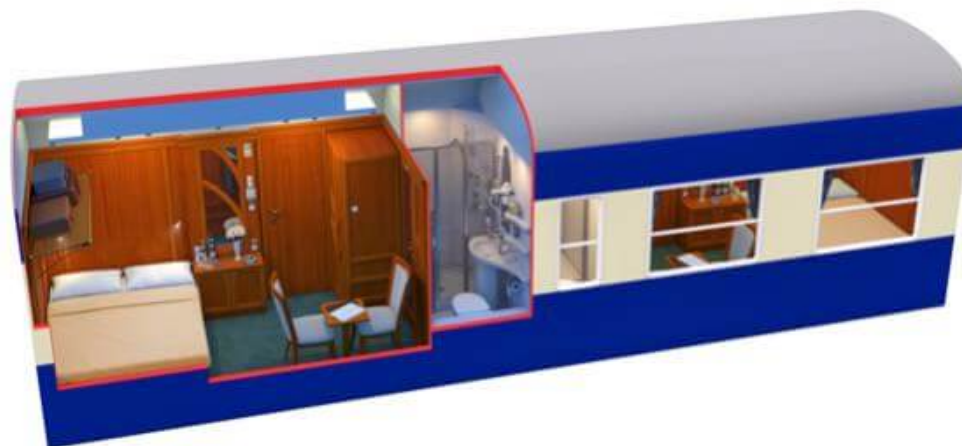

DELUXE

Each deluxe sleeper carriage has just five spacious yet intimate en-suite cabins offering every convenience and comfort so you may sit back, relax and enjoy the scenery as it rolls by.



Photos and illustrations are for guidance only and may differ to your actual cabin

DELUXE

Private bathrooms feature a shower with constant hot water, washbasin and toilet. There is a heated towel rail, shaver socket and hairdryer. A range of toiletries and a dressing gown are provided. Cabins have individually controlled air-conditioning, lighting with dimmer switches, individual reading lights, power sockets and a safe. Co-ordinated fabrics complement wood-panelled walls and brass fittings. Two comfortable armchairs provide daytime seating and a free-standing chair adds flexibility. Cupboards and a full length wardrobe provide ample storage whilst the large picture window and full length mirror enhance the spacious feel. A second window will open for fresh air and for that perfect photo opportunity.



Photos and illustrations are for guidance only and may differ to your actual cabin.

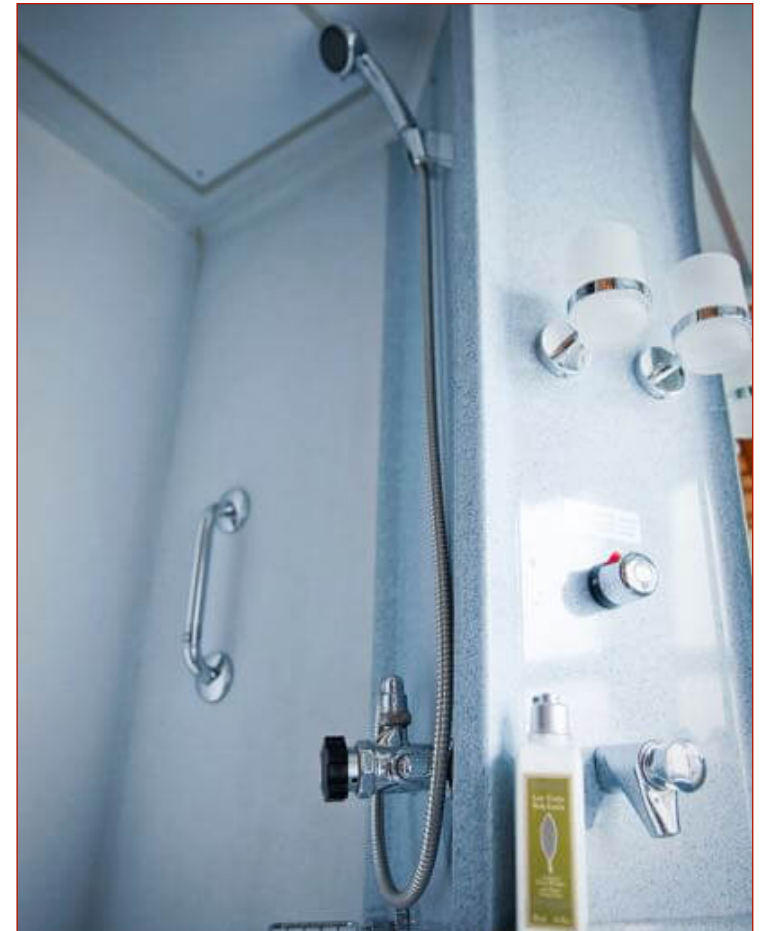

DELUXE

Photos and illustrations are for guidance only and may differ to your actual cabin.

- 5 x 2-bed cabins per carriage
- Cabin size (inc. bathroom): 397cm x 195cm
- Cabin area (inc. bathroom): 7.74m² (83 ft²)
- Bed size (each): 185cm x 80cm (6ft 1" x 2ft 7.5")
- Private en-suite bathroom with cubicle shower & wc: 77cm x 195cm 1.5 m² (16 ft²)
- Remote controlled air-conditioning
- Two armchairs and a free standing chair for daytime seating
- Large picture window – opens partially, perfect for photograph opportunities
- Full length wardrobe and power sockets
- During dinner each evening the living room is converted into two comfortable lower beds by your attendant who is also on hand to bring you early morning tea or coffee.

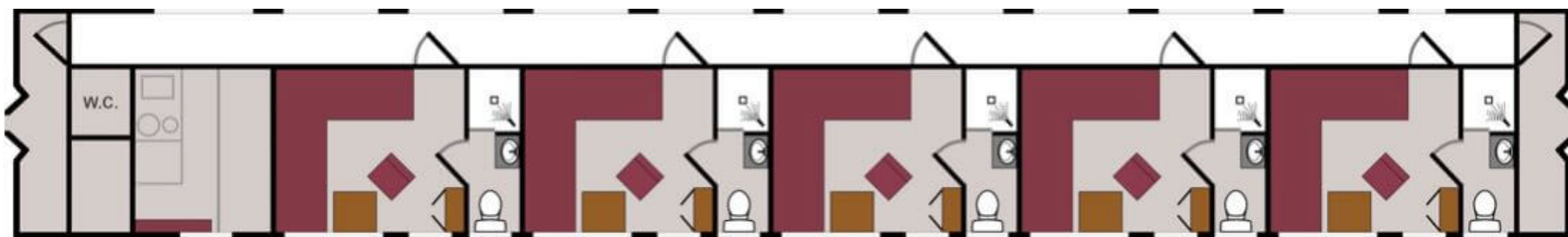

GOLDEN EAGLE DANUBE EXPRESS - CABIN COMPARISONS

	DELUXE CABIN	SUPERIOR DELUXE CABIN
CABIN AREA	83 sq ft (7.7 sq m)	93 sq ft (8.6 sq m)
CABINS PER CARRIAGE	5	4
DAYTIME CONFIGURATION	Two armchairs and a free-standing chair	Full length sofa, 2 Additional chairs and table
NIGHT TIME CONFIGURATION	2 lower L shaped Twin Beds	King Size Bed (UK standard)
BED SIZE	Each bed: 6ft 1ins x 2ft 74ins / 185cm x 80cm	6ft 2ins x 5ft 0ins / 190cm x 152cm
BATHROOM	Private en-suite bathroom with cubicle shower and WC	Private en-suite bathroom with cubicle shower and WC
AIR CON / HEATING	Remote controlled air-conditioning	Individually controlled air conditioning and heating
LIGHTING	Dimmer switches, Individual reading lights	Dimmer switches, Individual reading lights
WINDOW	Large picture window – opens partially	Two large picture windows
WARDROBE/STORAGE	Full length wardrobe	Double wardrobe & personal safe, additional cupboards
Wi-Fi / USB	Wi-Fi	Wi-Fi & two USB ports
ADDITIONAL AMENITIES	Bathrobes, slippers hair dryer and luxury toiletries provided	Bathrobes, slippers hair dryer and luxury toiletries provided
DRINK INCLUSIONS	Complimentary Drinks in the Bar Lounge Car	Complimentary Drinks in the Bar Lounge Car
LAUNDRY INCLUDED	Charge applies	Charge applies

GOLDEN EAGLE DANUBE EXPRESS IMPORTANT INFORMATION

• WHAT IS INCLUDED IN THE PRICE?

All accommodation as per the itinerary - both on board the train and in hotels; all meals starting with dinner on the first day; a generous allowance of wine, beer, soft drinks and tea and coffee with all lunches and dinners both on and off the train; all arrival and departure transfers; guided off-train sightseeing excursions; the services of experienced Tour Leaders; all gratuities; and a Doctor travelling with the group. We do not take any responsibility for any passengers in possession of incorrect or invalid visas. Please contact our Customer Services department for help and information. For customers in the United Kingdom we can put you in contact with our recommended visa support agency.

• INSURANCE

It is a booking condition that you must be fully insured for any medical expenses that may be incurred whilst travelling. You will be asked to provide us with the name of your insurer and your policy number together with the 24-hour medical emergency assistance contact number. We will require this information at least six weeks prior to travelling with us.

• VACCINATIONS

We will continue to look for the most up-to-date health and safety recommendations from both the World Health Organization (WHO) and international governments, including vaccination requirements for Covid-19, and will continue to update our policies accordingly for your added peace of mind.

• ON BOARD DOCTOR

We provide a Doctor on board all our tours who is available 24-hours a day. They carry a fully stocked medical kit but it is your responsibility to ensure that you obtain any vaccinations, prescribed and precautionary medicine for the countries you are visiting before travelling with us.

• INTERNATIONAL & DOMESTIC FLIGHTS

Flights are not included (unless part of the itinerary) but we can advise fares and book them for you if the flights originate in the UK. Please note that we do not advise that you book flights more than 60 days in advance of the tour departure date (see Booking Conditions).

• HOTEL ACCOMMODATION

Hotel accommodation as described in the tour itinerary is included in the price of the tour. Room upgrades are available on request, subject to availability and at an additional cost.

• ITINERARIES

Accommodation and tour itineraries are subject to change at any time due to circumstances beyond our control. Every effort will be made to operate tours as advertised and as per the rail timings received.

• WHAT IS NOT INCLUDED IN THE PRICE?

International and domestic airfares (unless part of the itinerary); visa and excess baggage charges; insurance. Personal expenses such as drinks in the Bar Lounge Car or laundry. On some tours there may also be an occasional optional activity that needs to be paid for locally.

• MEETING POINTS

Details of hotel/airport meeting points will be printed on the departure packs that will be sent to you one month prior to departure.

• ACCESS TO WI-FI

Wi-Fi is available on board for guest use whilst travelling in Europe. The Wi-Fi connection is dependent on cellular signal and there will be times when we will be travelling through areas with limited or zero coverage. Therefore, please do not expect a reliable service when the train is moving through remote areas.

• PASSPORT AND VISA INFORMATION

It is your responsibility to be in possession of a valid passport and visa for your trip. A passport with a minimum of 6 months validity is required for all our rail tours. Many of the remote and exotic countries we visit require visas. Visa costs are not included in the price of the tour and these must be purchased independently. This can often be an involved and time consuming process and, as this is such an important aspect of your holiday, we can assist you with advice and any supporting documentation.

• SINGLE TRAVELLERS

Many of our guests are single travellers and of course passengers travelling as small groups, families, couples or singles are all equally welcome.

• SPECIAL REQUESTS

We pride ourselves on offering you a personalised and knowledgeable service and will make every effort to meet any of your special dietary, room or travel requests. Also we are very happy to cater for any special occasion or anniversary that you are celebrating whilst you are with us. Please advise us at the time of booking.

• GRATUITIES

All gratuities are included in the tour price and we strongly encourage passengers to refrain from offering gratuities to crew/hoteliers/drivers etc. We would prefer passengers to inform our management of any exceptional service received, and we will reward accordingly.

• LANGUAGE

The primary tour language will be English. French, German and Spanish speaking guides are available on request at an additional cost. Please contact us for more information. Other languages may be available on request.

• TRAVELLER HEALTH CONDITIONS

To get the most out of our tours, passengers must be able to walk at least a mile per day at normal walking speed. The traveller represents that neither he/she has any physical or mental condition or disability that could create a hazard to him/herself or other members of the tour. We reserve the right to refuse travel to anyone who, in the opinion of the Tour Doctor or Tour Manager would be incapable of completing the tour or would cause unacceptable delays to the rest of the group. In these circumstances there would be no refund for any unused part of the tour. If in doubt, please call us for advice.

• MINIMUM PASSENGER REQUIREMENTS

All our rail tours require a minimum number of passengers to operate. Should this not be reached, we will offer an alternative tour. If no alternative is suitable a full refund will be offered.

• BOOKING CONDITIONS

Our full booking conditions can be found at <https://theluxurytraintravelcompany.com/booking-terms-conditions/>

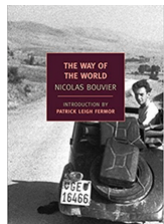

THE WAY OF THE WORLD

NICHOLAS BOUVIER

A well-written travelogue, and one of only a handful that deserves to still be read today, both for its style, as well as its unsurpassed account of the regions traveled. From the Balkans to Turkey, 2 artists bumble slowly across Iran, Pakistan and Afghanistan in the early 50's.

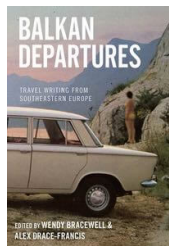

BALKAN DEPARTURES

WENDY BRACEWELL & ALEX DRACE-FRANCIS

The Balkan region's writers have given accounts of their travels in the West and elsewhere, saying something in the process about themselves and their place in the world. This book challenges assumptions of Western discursive hegemony, while at the same time exploring Balkan 'Occidentalisms'.

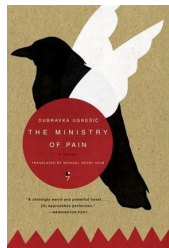

THE MINISTRY OF PAIN

DUBRAVKA UGREŠIĆ

The Ministry of Pain is a historical book on the convoluted past of Yugoslavia, as well as a realistic, comic, and heart-felt chronicle of the lives of a group of Balkan refugees who study in the Netherlands, guided by their young teacher Tanja Lucić.

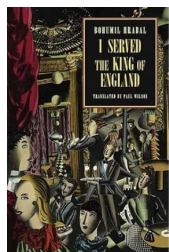

I SERVED THE KING OF ENGLAND

BOHUMIL HRABAL

In The Grand Budapest Hotel film takes Bohumil Hrabal's fluid whimsy and reduces it to the consistency of syrupy, saccharine quirkiness. I Served the King of England gets its dues in Paul Wilson's light-handed translation. This is one of Central Europe's great hotel novels, witty and deep, set in Prague, and the city's provincial clones.

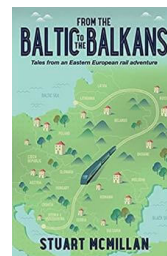

FROM THE BALTIC TO THE BALKANS

STUART MCMILLAN

Inspired by a life-long passion for travel, Stuart McMillan embarked on a journey of over 2,000km, crossing the continent from the Baltic Sea to the Balkan coast. The book provides personal observations and reflections on a fascinating world hidden for decades behind an Iron Curtain.

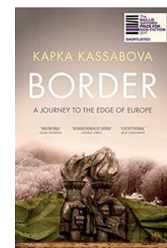

BORDER: A JOURNEY TO THE EDGE OF EUROPE

KAPKA KASSABOVA

When Kapka Kassabova was a child, the borderzone between Bulgaria, Turkey and Greece was rumoured to be an easier crossing point into the West than the Berlin Wall so it swarmed with soldiers, spies and fugitives. Border is a sharply observed portrait of a little-known corner of Europe.

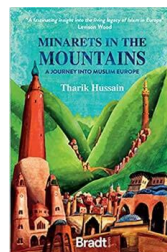

MINARETS IN THE MOUNTAINS

THARIK HUSSAIN

A magical, eye-opening account of a journey into a Europe that rarely makes the news and is in danger of being erased altogether. Another Europe. A Europe few people believe exists and many wish didn't. Muslim Europe.

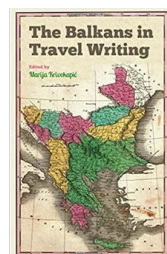

THE BALKANS IN TRAVEL WRITING

MARIJA KNEŽEVIĆ

This book revisits images of the Balkans in twentieth-century travel writing that vividly mirrors the turbulent changes that the region went through.